

FIRST FLOOR PLAN

TYPICAL FLOOR PLAN(2ND&3RD)

TERRACE FLOOR PLAN

PLAN SHOWING PROPOSED BUILDING FOR Mrs. ARTHI GANESH, TRUSTEE, VELS INSTITUTE OF SCIENCE TECHNOLOGY AND ADVANCED STUDIES (VISTAS) AT S.NO:192/L, T.S NO.1/1 AND 1/2, ZAMIN PALLAVARAM, PALLAVARAM MUNICIPALITY, KANCHEEPURAM DISTRICT.

MEASUREMENTS ARE IN METERS   SHEET NO:2/3	
AREA STATEMENT	F.S.I SQ.M
EXTENT OF PLOT AS PER PATTI	4554.00
EXTENT OF PLOT AS PER DOC	4554.00
EXTENT OF PLOT AS PER SITE	4554.00
GROUND FLOOR AREA	1704.62
FIRST FLOOR AREA	1704.62
SECOND FLOOR AREA	1704.62
THIRD FLOOR AREA	1704.62
TOTAL BUILT UP AREA 6818.48	
FLOOR SPACE INDEX :	1.497
PLOT COVERAGE :	37.90%

TOTAL NO OF CARS :36
TOTAL NO OF T/W :71
TOTAL NO OF CYCLES :306
SPECIFICATION:
FOUNDATION - RCC COLUMN FOOTINGS
BRICK WORK - C.M 1:6 FOR SUPER STRUCTURE
PLASTERING - C.M 1:5 FOR WALLS & 1:3 FOR CEILING
FLOORING - MOSAIC FLOORING
CEMENT PAINT - TWO COATS FOR WALLS & ONE EXTRA COAT FOR CEILING
R.C.C - M25 GRADE FOR ALL CONCRETE WORKS
WOOD WORK - ALL WOOD WORKS IN BEST QUALITY TIMBER
WEATHERING COURSE - AS PER NATIONAL BUILDING CODE

COLOUR INDEX	SCHEDULE OF JOINERY
PROPOSED	MD MAIN DOOR - 3.05 x 2.13
ROAD	D DOOR - 1.22 x 2.13
BOUNDARY	D1 DOOR - 0.91 x 2.13
	D3 DOOR - 0.75 x 2.13
	W WINDOW - 1.20 x 1.37
	W1 WINDOW - 3.51 x 1.37
	V VENTILATOR - 1.83 x 0.60
	V1 VENTILATOR - 0.60 x 0.60

SCALE : 1:500

OWNER SIGNATURE  
 DR. ARTHI GANESH TRUSTEE  
 VELS INSTITUTE OF SCIENCE TECHNOLOGY AND ADVANCED STUDIES (VISTAS)  
 LICENSED SURVEYOR  
 E. T. RAMAKRISHNAN  
 (R.E. CIVIL) M. Eng. (Structural)  
 Licensed Surveyor Class-4 No. 2069  
 Corporation Of Chennai  
 77-A, Light House Road,  
 Anna Nagar Westam Estate,  
 Chennai-600 092



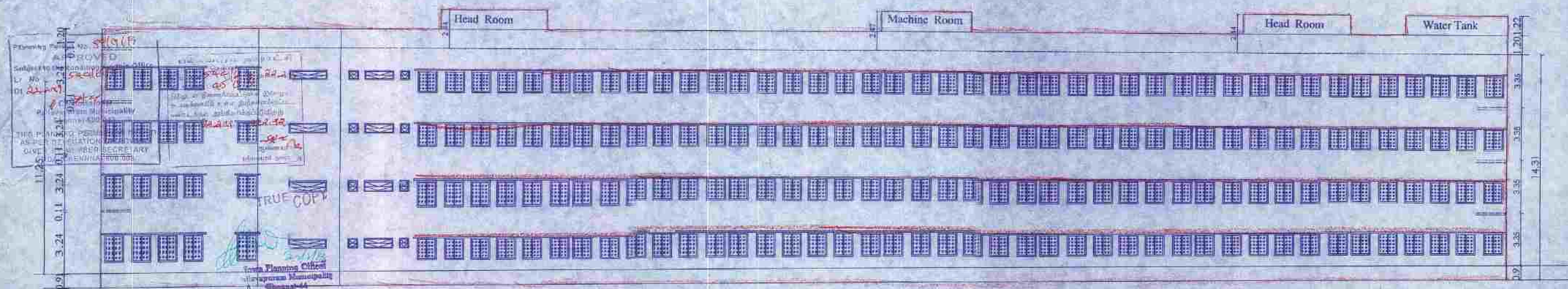

WESTERN SIDE ELEVATION

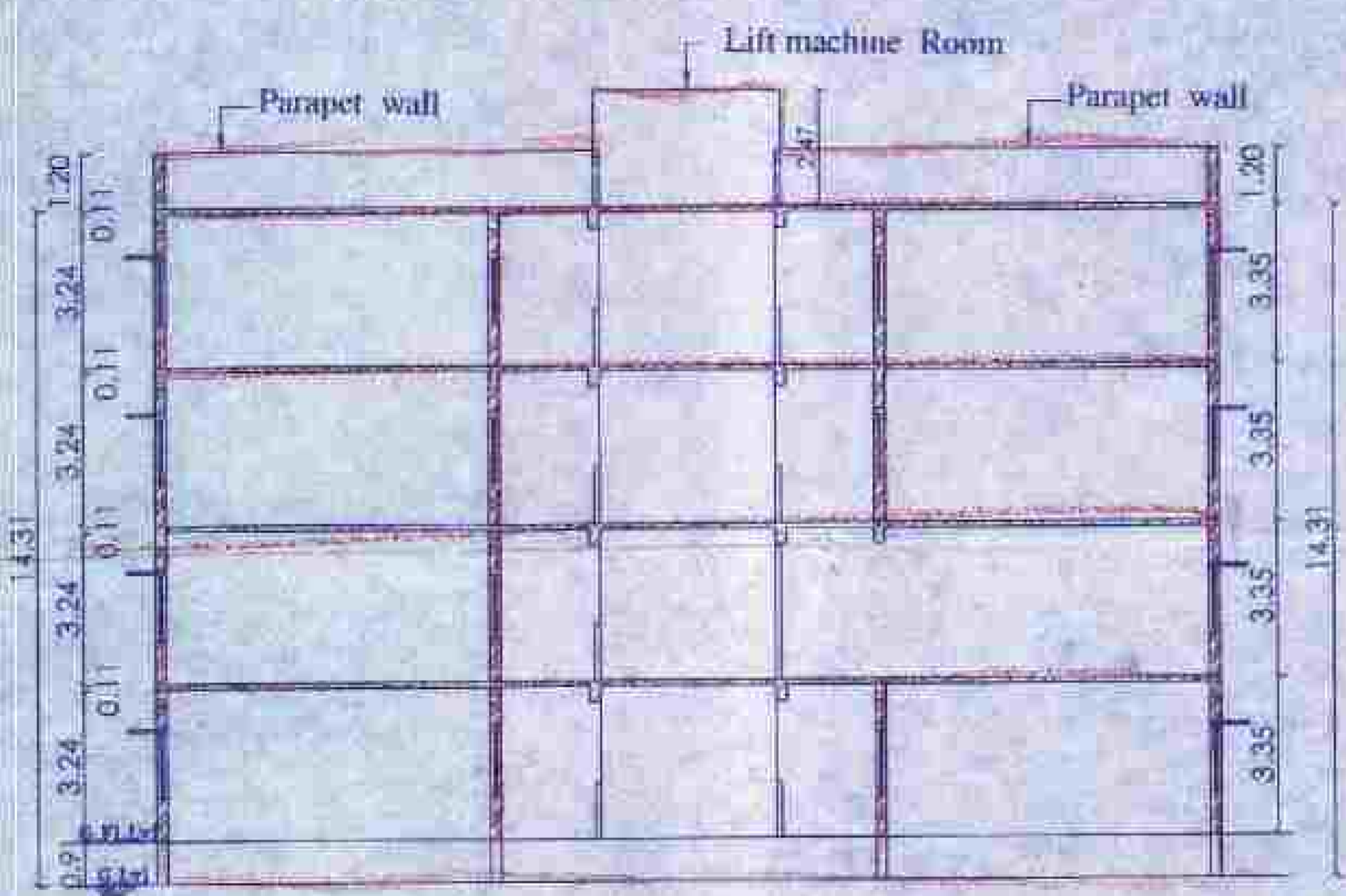

SECTION @ A-A

COLOUR INDEX		SCHEDULE OF JOINERY	
PROPOSED		MD MAIN DOOR	- 3.05 x 2.13
ROAD		D DOOR	- 1.22 x 2.13
BOUNDARY		D1 DOOR	- 0.91 x 2.13
		D3 DOOR	- 0.75 x 2.13
		W WINDOW	- 1.20 x 1.37
		W1 WINDOW	- 3.51 x 1.37
		V VENTILATOR	- 1.83 x 0.60
		V1 VENTILATOR	- 0.60 x 0.60

SCALE : 1:500

PLAN SHOWING PROPOSED BUILDING FOR Mrs. ARTHI GANESH, TRUSTEE, VELS INSTITUTE OF SCIENCE TECHNOLOGY AND ADVANCED STUDIES (VISTAS) AT S.NO:192/1, T.S NO.1/1 AND 1/2, ZAMIN PALLAVARAM, PALLAVARAM MUNICIPALITY, KANCHEEPURAM DISTRICT.

MEASUREMENTS ARE IN METERS SHEET NO:3/3

*Arthi*  
Dr. ARTHI GANESH  
TRUSTEE  
VELS INSTITUTE OF SCIENCE TECHNOLOGY  
AND ADVANCED STUDIES (VISTAS)

OWNER SIGNATURE

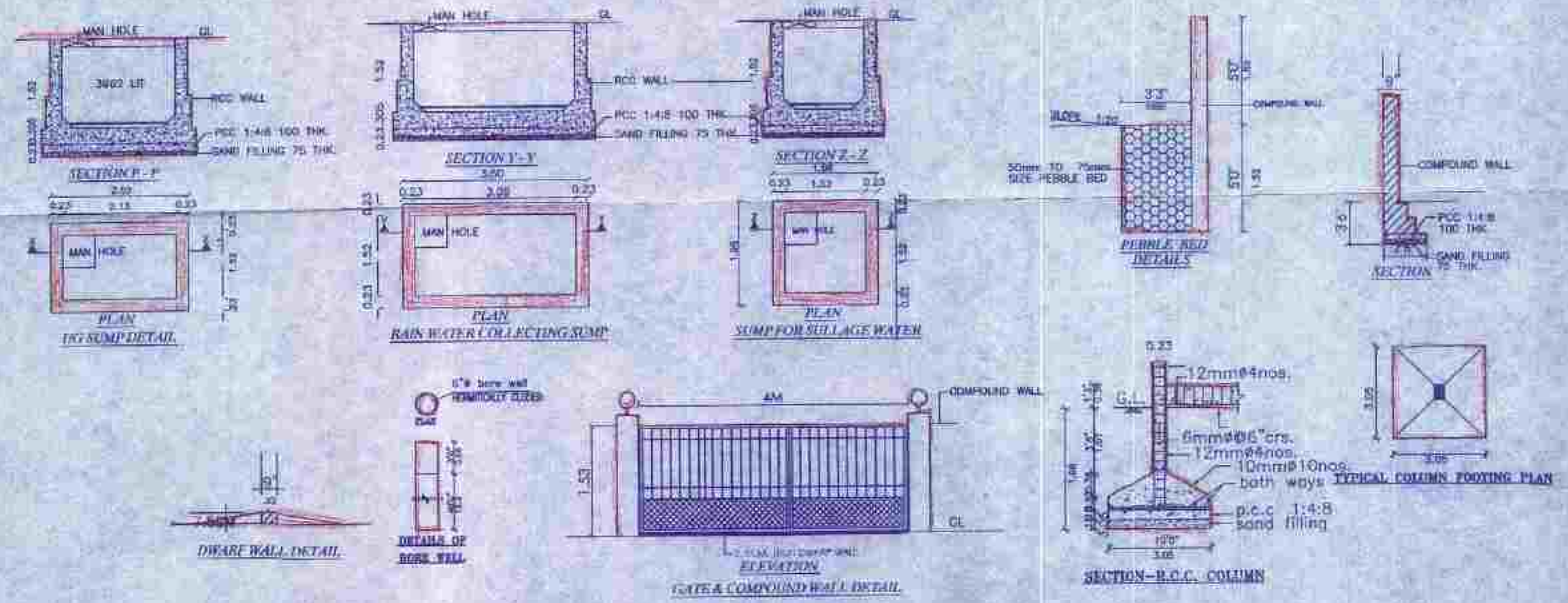

*[Signature]*  
E. I. RAMAKRISHNAN,  
B.E.C.E. (A), M.E. (Structures)  
Licensed Surveyor Class-I No. 24657  
Corporation of Chennai  
27B-A, East Main Road,  
Anna Nagar, Chennai-600030  
(Phone: 80101)

LICENSED SURVEYOR